



H48

WAREHOUSE BOOKLET

size warehouse: 3.500 m² size festival site: 5.000 m² indoor spaces available: 4 outdoor spaces available: 3

address: Hemkade 48, 1506 PS, Zaandam, The Netherlands

inquiries: info@hemkade48.nl

TABLE OF CONTENT

3. OUR STORY

4-6. FACTS & FIGURES

8-10. MAIN HALL

11-12. ENTRY HALL

13-14. THE BLACK BOX

15. HEINEKEN AREA

16. BACKSTAGE

17. THE TERRACE

18. BALKENHAVEN FESTIVAL SITE

19-25. THE IMPRESSIONS

26. SUPPLYING PARTNERS

27. CLIENT PORTFOLIO

behind every old warehouse is a story for the books



Originally functioning as a technical educational institute under Bruynzeel in the late 1940s. In 1984 when Moens Senior acquired it, this historic Bruynzeel Building, designed by F.A. Warners of the Amsterdam School and located in Zaanstad-Zuid on the Zuiderhout Industrial Estate, was initially repurposed as an indoor golf course and squash courts. However, it later underwent another metamorphosis, emerging as an event hall that would become the starting point for Ivar Moens and Pelle Moens' journey into realizing their passion for organizing parties and events.

The narrative unfolds further in 1994 when brothers Moens, driven by youthful ambition, founded the FunFactory, eventually gaining renown as "the Hemkade" and now acknowledged as the North Sea Venue. Originally established as an event hall, the Hemkade played a pivotal role in the burgeoning success of the two brothers, who emerged as trailblazers in the Dance scene.

**the
venue**

3.500 m²

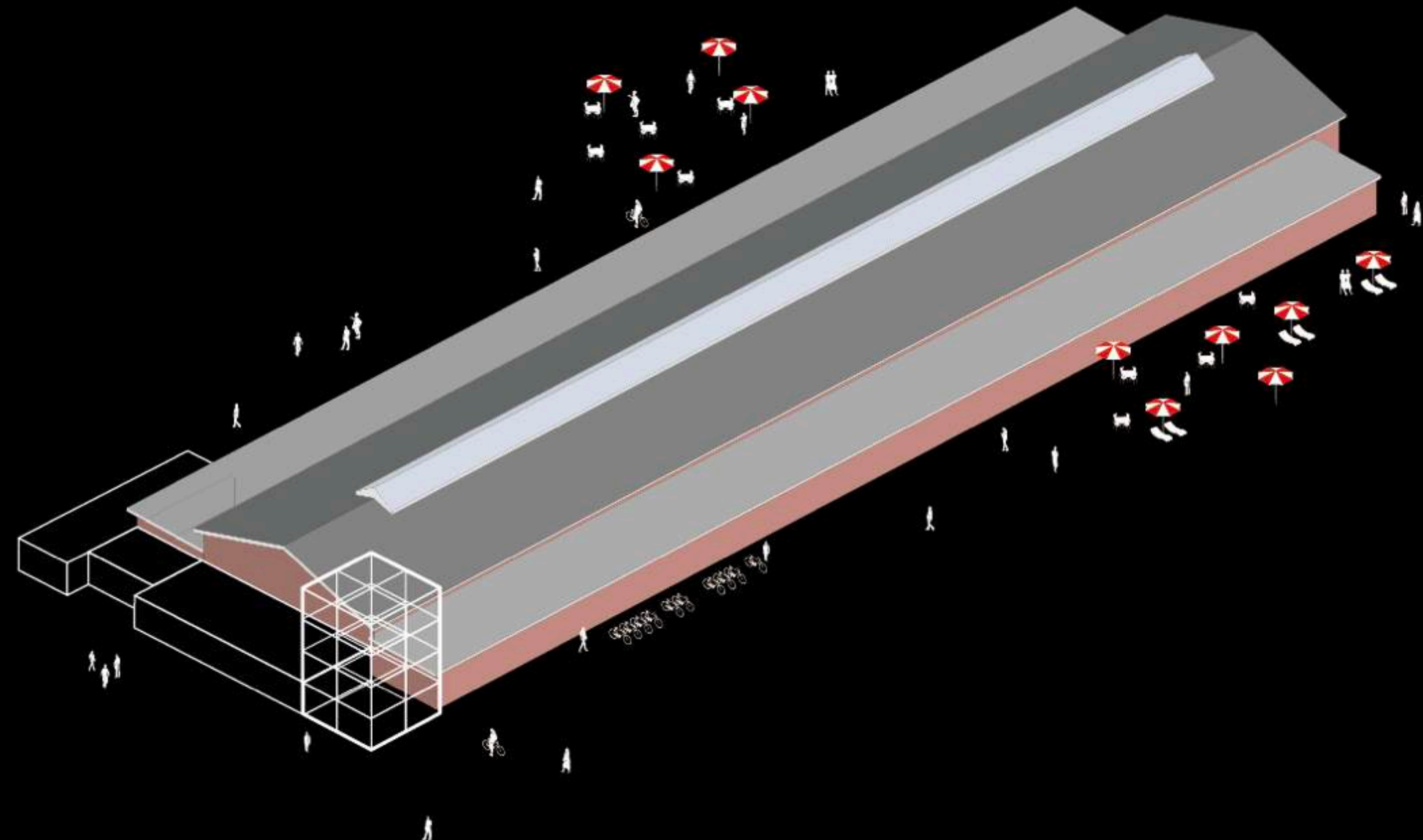

**outdoor terrace/
festival site**

5.000 m²

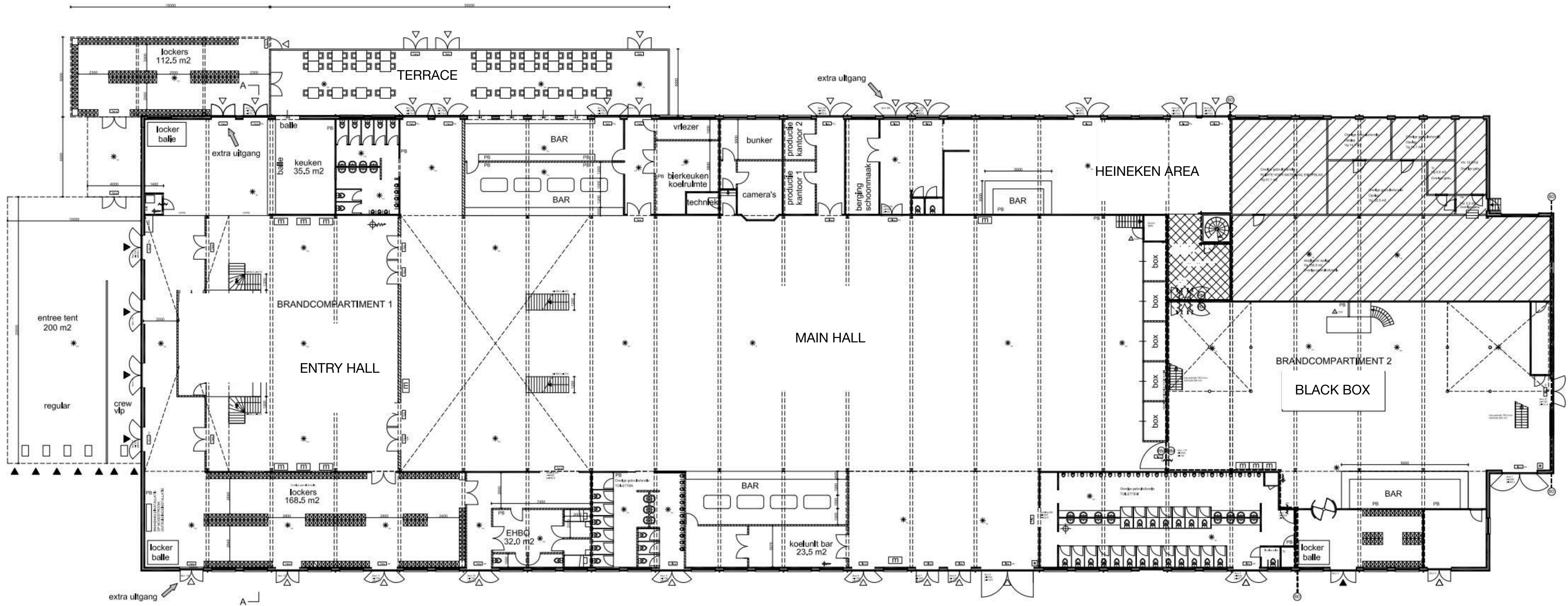

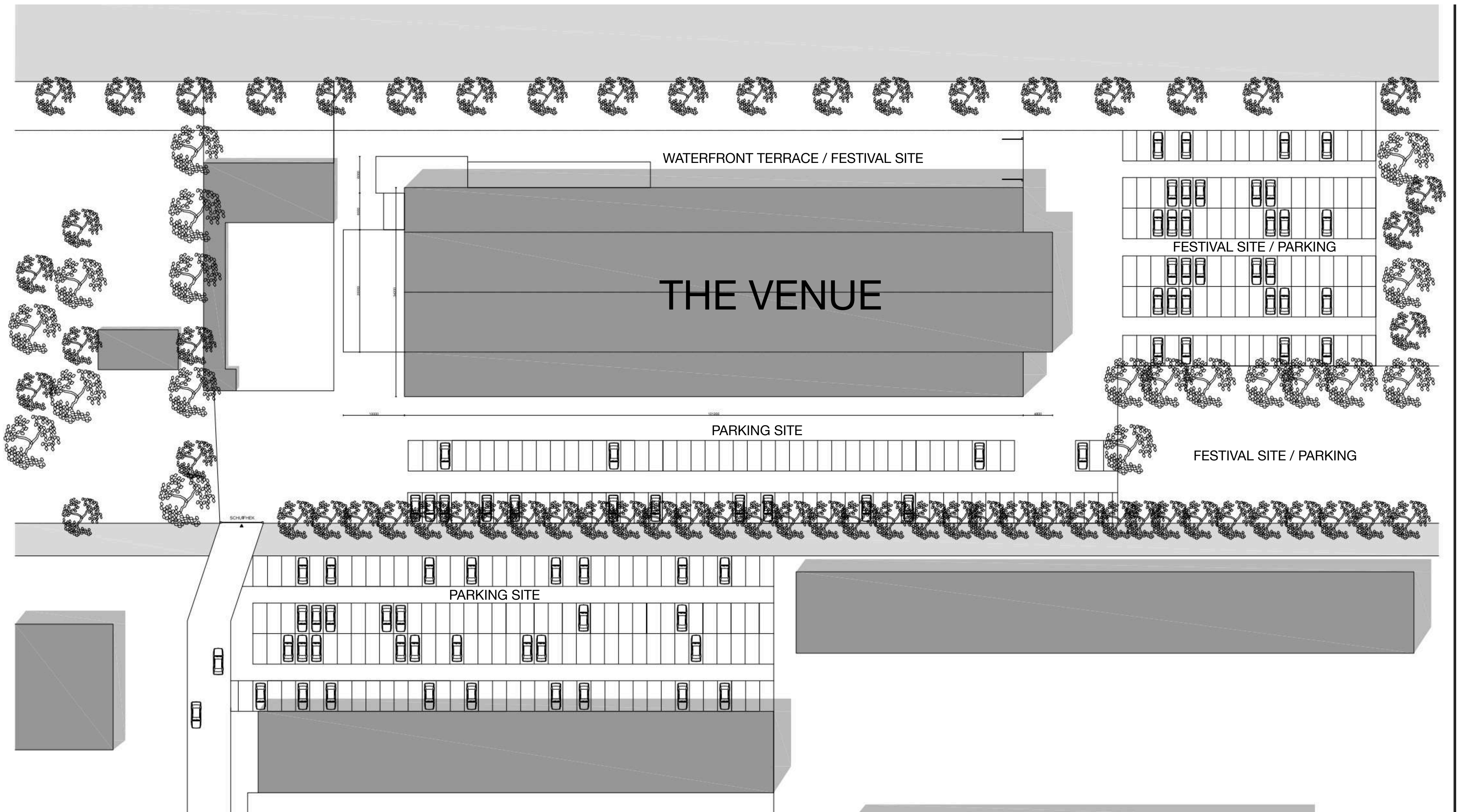

THE SPACES.

MAIN HALL



MAIN HALL

general

capacity: 3.200 pax (standing)

30m bar facility (left/right)

3 toilet groups

sound

12x L-Acoustics K-3 Line-Array

12x L-Acoustics KS-28 Subs

8x L-Acoustics A15i Focus

4x L-Acoustics X8 backstage

2x L-Acoustics monitor system A15 wide

2x L-Acoustics monitor system

KS21

1x Midas M32R + Snake

light

44x CLF AORUN

6x CLF Stinger

22x Martin Mac Aura Wash

6x Clay Paky Stormy CC RGBW

2x Coemar Profile

2x Coemar Fresnel

1x Luminex LumiNode 4

2x Jem ZR45

power

3x 32A

1x 63A

2x 2x220, 1x400volt



H4E

1.175 m²

H4B



ENTRY HALL



ENTRY HALL

400 m²

(where we welcome you.)

Step into our newly revitalized entry hall, designed to serve a multitude of purposes, fitting a capacity of 500 pax. Whether it's welcoming your visitors in style as a foyer or serving as a dedicated space to organize your events and line-up, this versatile area provides opportunities for integrating **light** and **sound** systems seamlessly. The hall is thoughtfully outfitted with distinct locker areas on both the right and left sides, a convenient toilet group, a 90-degree bar facility, and an equipped kitchen space for catering preparations.

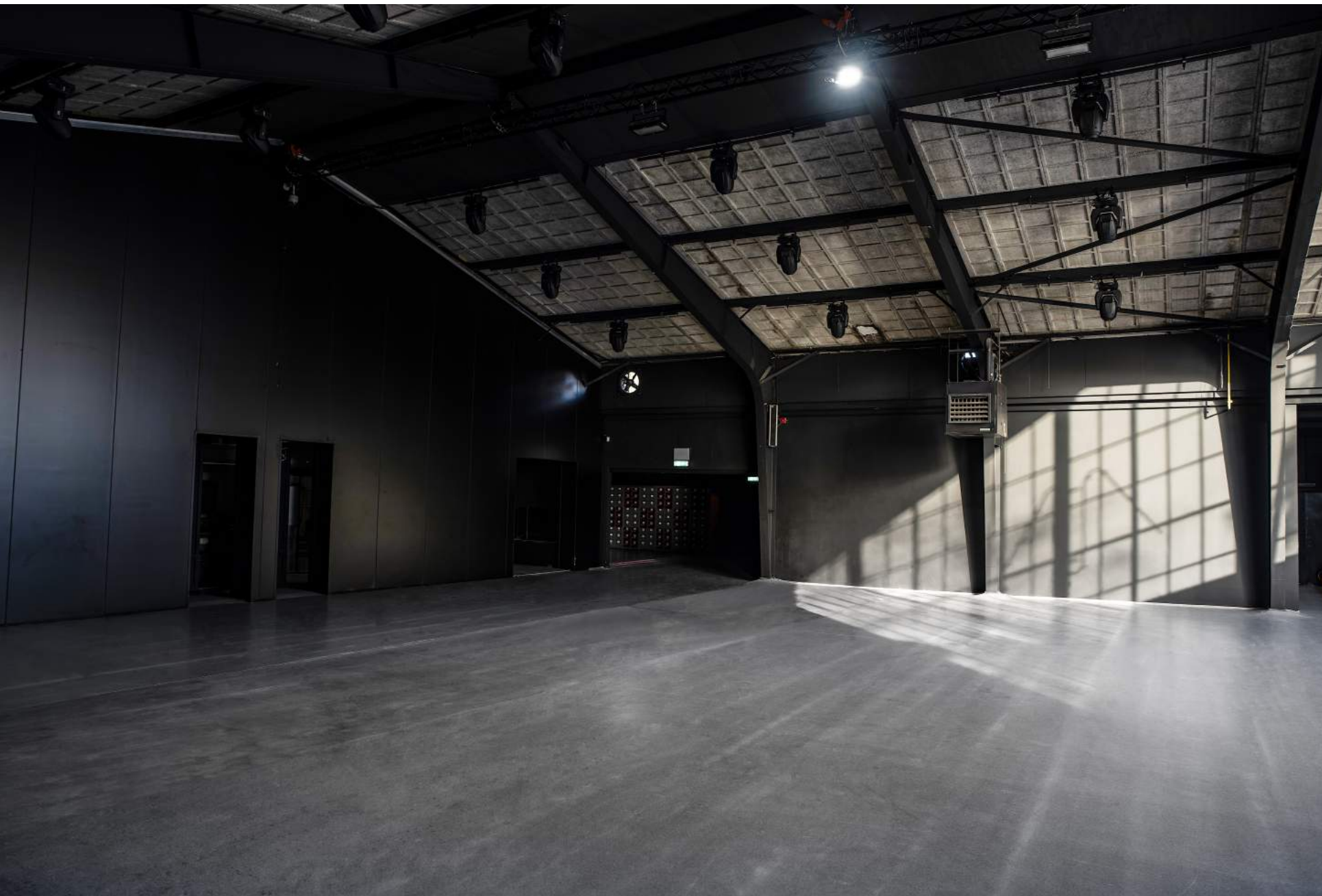



THE BLACK BOX

630 m²

THE BLACK BOX

Whatever secret is hidden in the black box stays there. Explore our industrial black box, which can be added to your event or used as a separate space for up to 1,000 people. The black box comes with its own lights, sound system, restroom facilities, a 5-meter bar, balconies on both sides, and a backstage area with changing rooms.



HEINEKEN AREA

The third subsection covers an area of 120 square meters and can accommodate up to 125 people. It is an ideal space for incorporating into your event as a sub-area or can be rented independently. The room comes fully equipped with sound and light systems, a bar, a restroom facility, and comfortable lounge seating.

GENERAL

capacity: 125 pax
(standing)

Sound & light systems

DJ booth

Seating furniture

3m bar facility

1 toilet group

120 m²





BACKSTAGE

"Behind the scenes, the backstage oasis awaits, where artists and DJs unwind in comfort, surrounded by tailored amenities that transform pre-show moments into a haven of relaxation and inspiration."

GENERAL

furnished backstage lounge

2 separate equipped changing rooms facilitated with mirrors & fridge & make-up table

1 VIP changing room facilitated with makeup table, fridge, private toilet, private shower & couches/seating

Sound & light systems

Backstage bar

Three private toilets



THE WATERFRONT TERRACE

The third subsection covers an area of 120 square meters and can accommodate up to 125 people. It is an ideal space for incorporating into your event as a sub-area or can be rented independently. The room comes fully equipped with sound and light systems, a bar, a restroom facility, and comfortable lounge seating.



5.000 m²

BALKENHAVEN FESTIVAL SITE

The Balkenhaven festival grounds span 5,000 square meters, providing a versatile outdoor space for a range of events, such as dance festivals, food festivals, or business events. This site can be utilized independently or in conjunction with the venue. When used separately, the festival grounds can accommodate a maximum of 3,000 attendees, and when combined with the venue, the overall capacity increases to 5,000 attendees.



THE IMPRESSIONS.

MAIN HALL



H4E

ENTRY HALL



HEINEKEN AREA



THE BLACK BOX



FESTIVAL SITE



H4E

THE WATERFRONT TERRACE



SUPPLYING PARTNERS



EVENT/CLIENT PORTFOLIO

EVENTS

Multigroove | Verknipt | VYBZ | Hellbound | Reminder | Crazyland | B.I.T.C.H. | Music ON
Vault Events | Boiler Room | Rampage | Defected | Teletech | Motionz | Vault Sessions
Breakfast Club | Jamrock | Snowbass Festival | Scantraxx | BKJN | NongKrong

B2B

Collecting Cars Ltd. | Porsche Nederland | XITE | Amsterdam Fashion Institute
Redbull Nederland | ASC/ASV | GGD Zaanstreek | Japan Light Festival

